

# BARFLOW



**CREATE YOUR  
UNIQUE BAR**

# WHERE DESIGN AND FUNCTIONALITY UNITE

## Welcome to Bar Flow

an exclusive stainless steel bar system, **thoughtfully crafted for professionals** who refuse to compromise on quality, performance, or aesthetics. With roots in the proud **Danish design** tradition and production carried out at our **specialized factory in the Czech Republic**, it brings together timeless style, high efficiency, and tailored functionality in one cohesive and fully integrated system.

Whether you manage a bar, hotel, or restaurant, this system is designed to meet the highest demands of the hospitality industry –

both in terms of appearance and day-to-day performance. This system is not just a working tool, but an **essential part of the complete bar experience**.

Developed in close collaboration with experienced industry professionals, each setup is always customized to match the specific needs of your workspace. Every detail is considered to optimize workflow, enhance ergonomics, and maximize use of available space. **Bar Flow is more than a bar system – it's a complete professional tool that elevates both visual impact and operational efficiency.**

## WHAT CAN YOUR PROJECT LOOK LIKE? ENDLESS WAYS TO BUILD YOUR BAR

From the first sketches and technical drawings through production and packaging ...

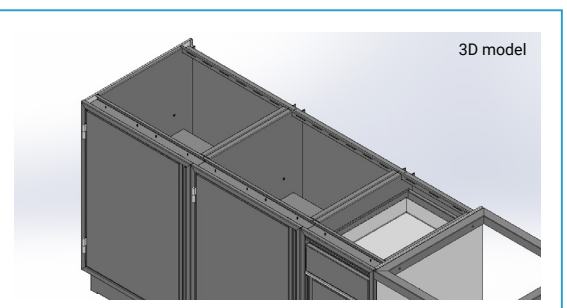
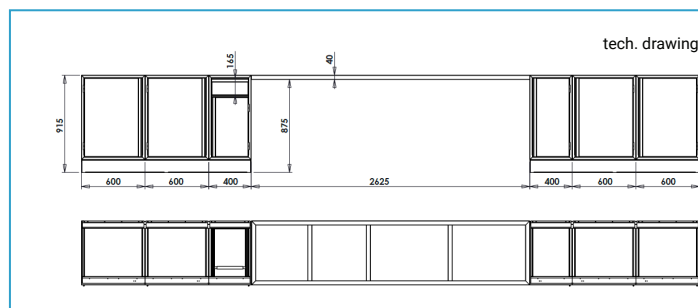
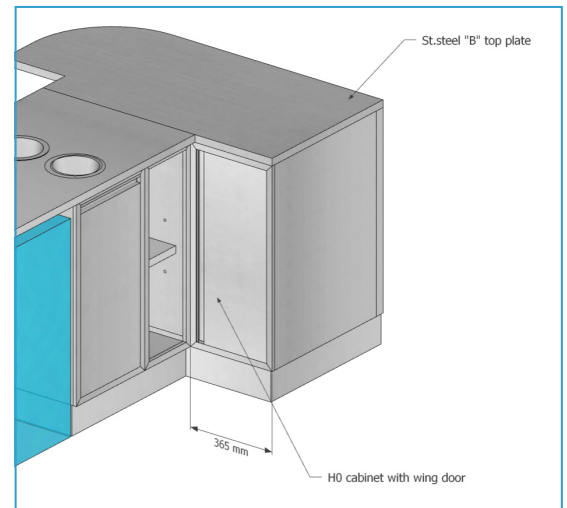
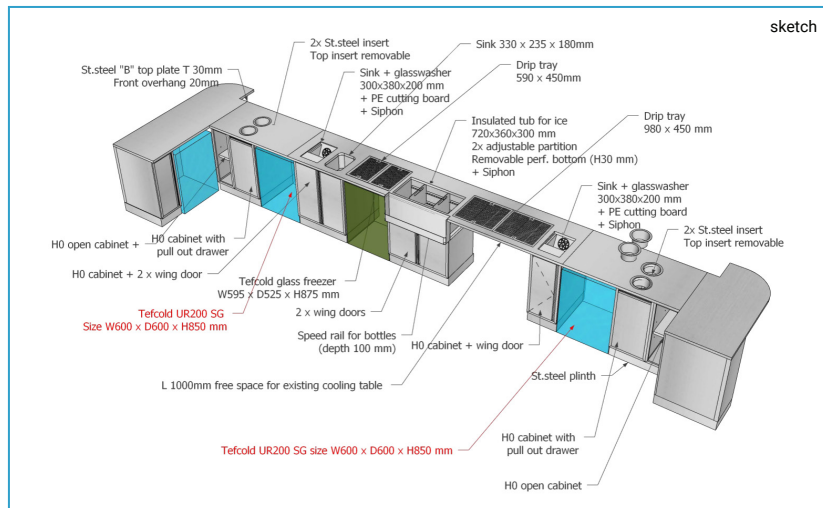

**Project:** Skodsborg Spa Hotel, Denmark

... to delivery and assembly at your location.



**Realized project:** Skodsborg Spa Hotel, Denmark





## Realized project: Grønlandsbaren, Greenland

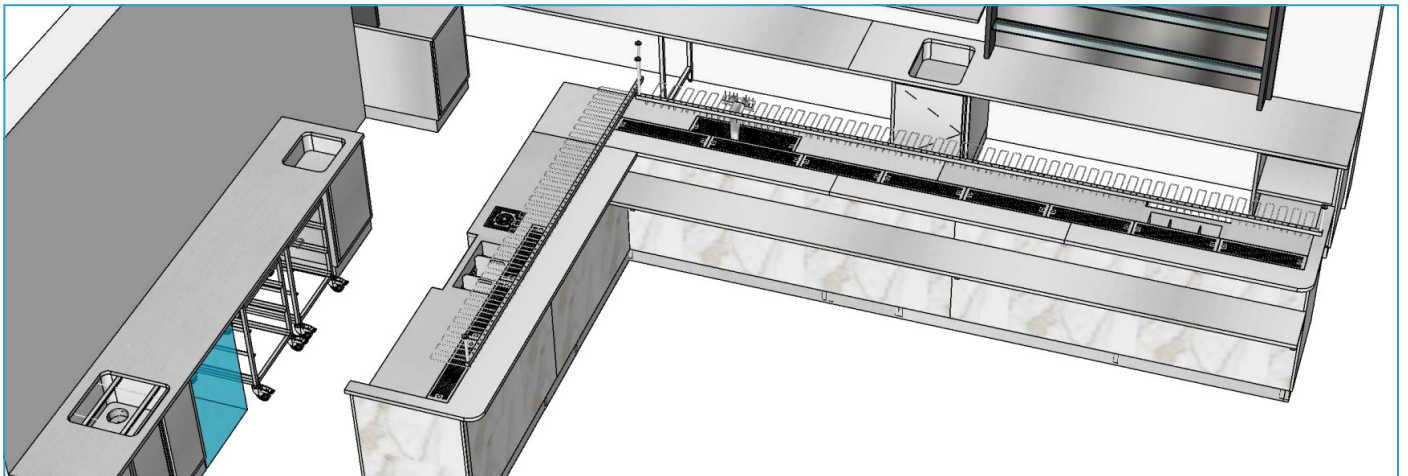
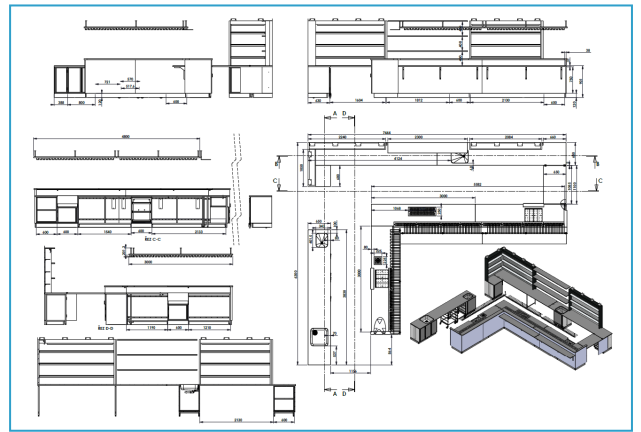
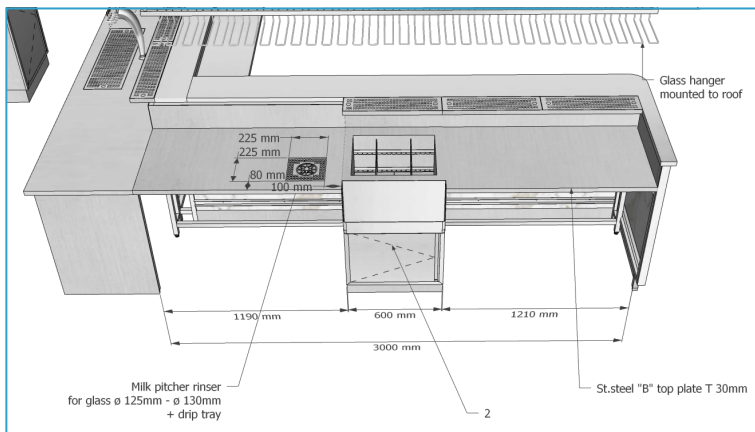



Realized project: Imperial Riding School Hotel, Austria

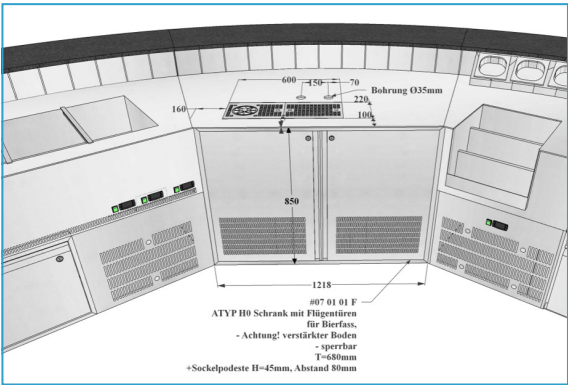
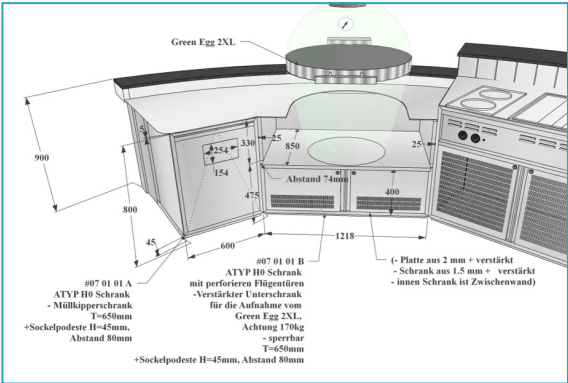
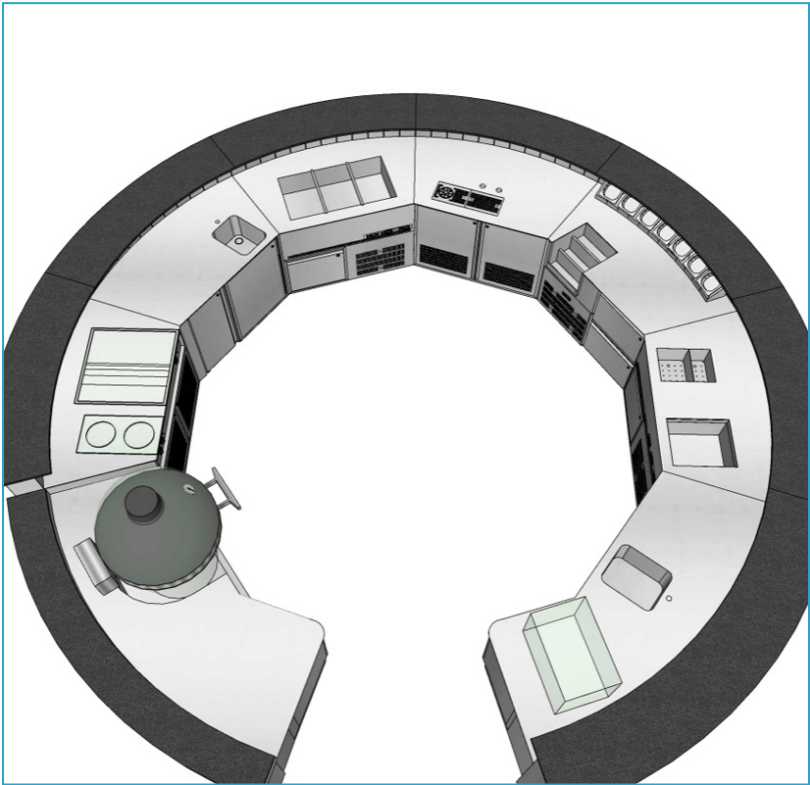



# 3D VISUALIZATION

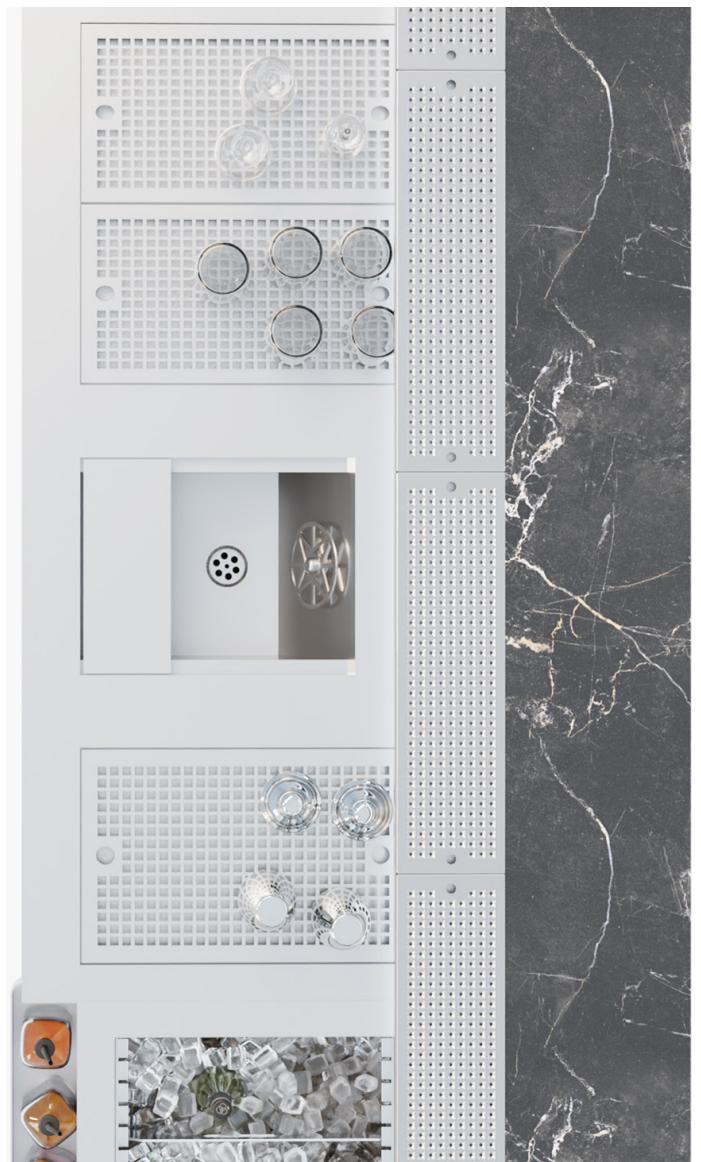

Front view - Bar cooler, LED lighting under the top bar plate.



Front view - LED lighting at the bottom.



Back view - LED lighting at the bottom.

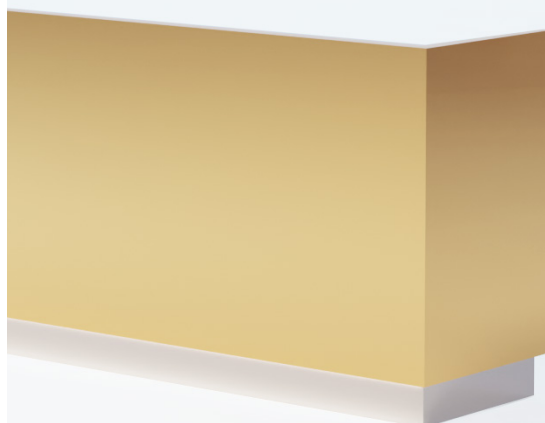



**Choose your colors and materials** — wood cladding around the bar or bar top plate made of wood or granite, so that your bar setup looks exactly the way you want.

This is just a small preview. You can find all the decors, where everyone can choose, at [www.kronospan.com](http://www.kronospan.com) or [www.egger.com](http://www.egger.com)



**Cotta Cremona  
Oak**



**Torro Cremona  
Oak**



**Flamed Arvadonna  
Chestnut**



**Charcoal Arvadonna  
Chestnut**

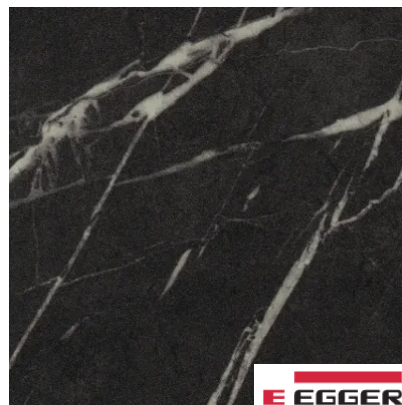

**Pietra Grigia  
Black**

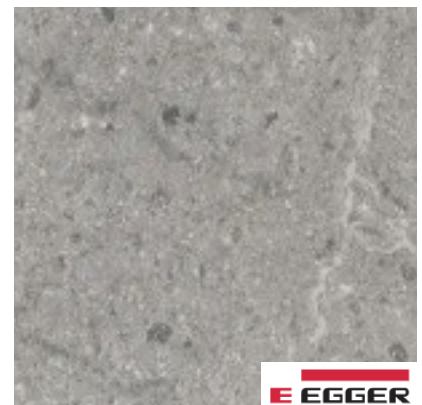

**Candela Marble  
light gray**



**Denver Oak  
truffle brown**

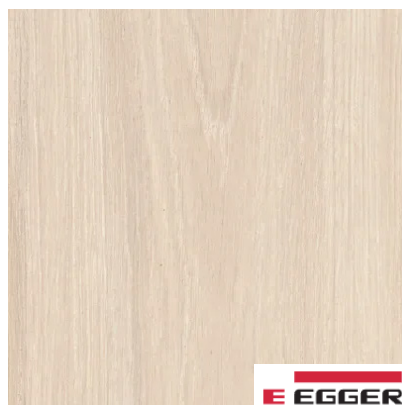

**Casella Oak  
White**



**Casella Oak  
Brown**



## TYPE OF CONSTRUCTION

## Type A

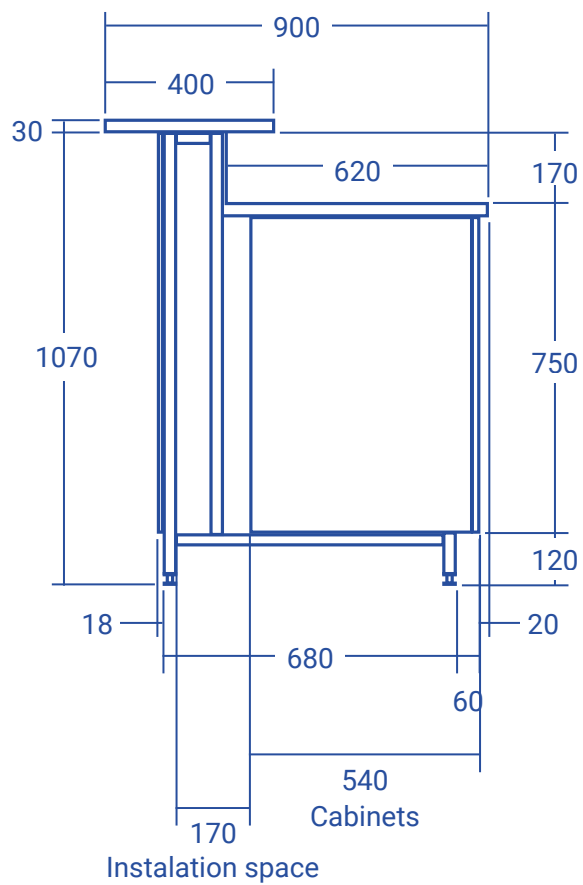

## Type B

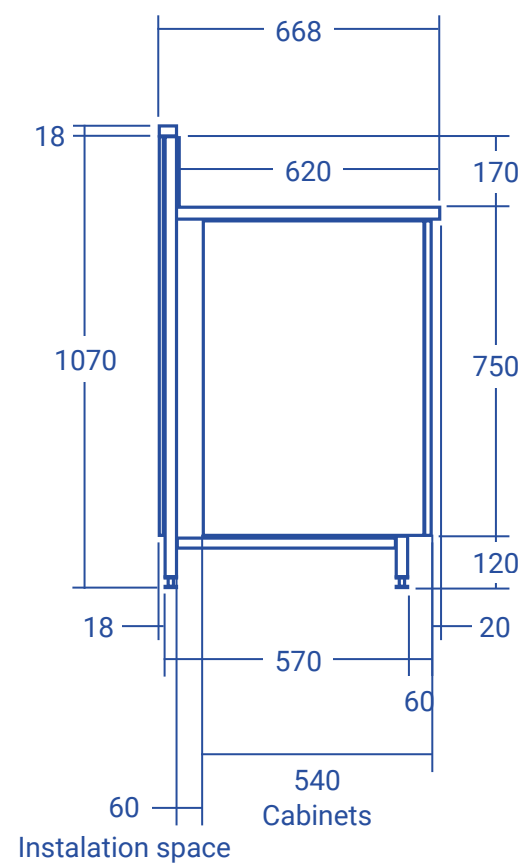

## Detailed view of the connection between the S/S worktops

front view (cut through screw and nut)

### Standard connection

(Sheet bending – silicone is applied into the gap, and then the panels are tightened together, which achieves reinforcement.)

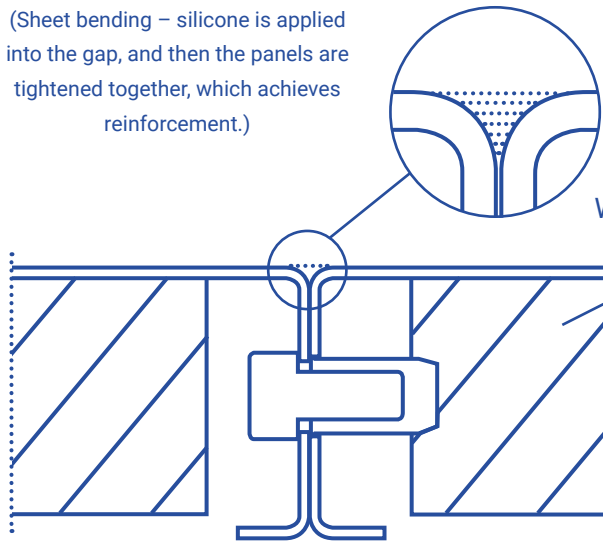

### Superthin connection

(Welding – silicone is applied between the panels and then the panels are tightened together, which results in a smaller amount of silicone used.)

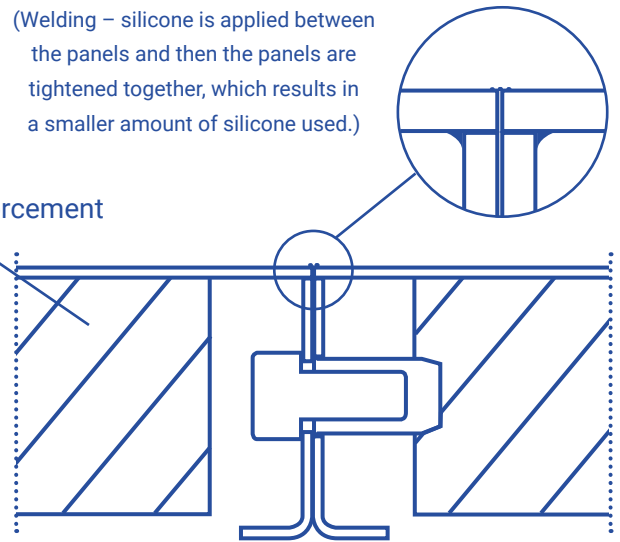

### Screw used to fasten the worktops

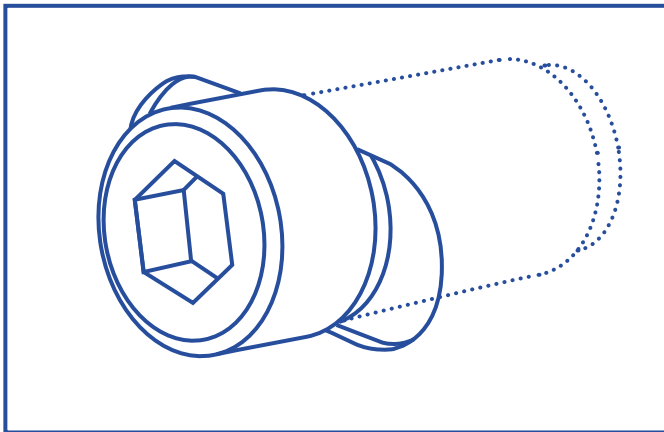

### Bottom view - connection between two S/S worktops

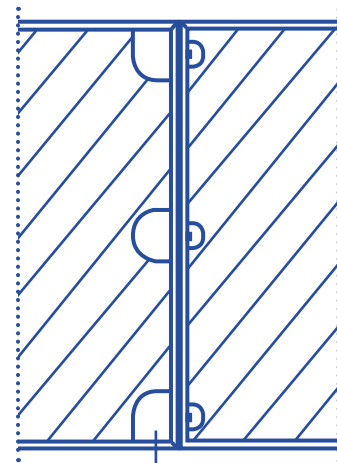

a cutout is made in the wooden core to allow easier access with an Allen key for tightening or loosening the screw

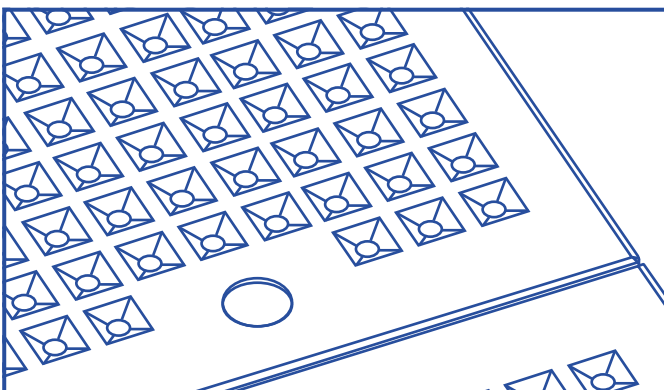

### New type of drip tray (for type A)

Pyramid-shaped holes that prevent the water jet from splashing when it hits the grate, thus avoiding water all over the place!



## STAND

**Type A**  
V1-015506-0010



**Sides for Type A**  
left side - V1-015506-0012  
right side - V1-015506-0013



**Bar top plate**  
V1-015506-0016



**Type B**  
V1-015506-0011



**Sides for Type B**  
left side - V1-015506-0014  
right side - V1-015506-0015



## HOW TO ASSEMBLE AND ORDER CORRECTLY?

First, select the type of construction, then choose the stand and matching sides, where you can decide whether you want both sides or just one. For construction type A, you can also choose a top bar plate made of stainless steel, stone, or wood, in a decor that suits your style. After that, it's time to select the internal layout—cabinets, top plate...

# CABINETS



**Cabinet with wing door  
+ 1 height adjustable shelf**

**width 400mm**  
V1-015506-0100

**width 600mm**  
V1-015506-0101



**Cabinet with wing door**

**width 400mm**  
V1-015506-0102

**width 600mm**  
V1-015506-0103



**Cabinet with pull-out drawer  
for trash**

**width 400mm**  
V1-015506-0108



**Open cabinet  
+ 1 height adjustable shelf**

**width 400mm**  
V1-015506-0104

**width 600mm**  
V1-015506-0105



**Open cabinet**

**width 400mm**  
V1-015506-0106

**width 600mm**  
V1-015506-0107



**Cabinet with tilting bin  
for trash**

**width 400mm**  
V1-015506-0109





**Cabinet with 2 drawers**

**width 400mm**  
V1-015506-0110

**width 600mm**  
V1-015506-0111



**Cabinet with 3 drawers**

**width 400mm**  
V1-015506-0112

**width 600mm**  
V1-015506-0113



**Cabinet with 3 telescopic  
basket sliders**

**width 600mm**  
V1-015506-0114



**Bar cooler with wing doors**

880x530x890

Power input: 1.9kWh/24h, Voltage: 1, N, PE ~ 220-240V, 50Hz,  
Cooling medium: R600a (65g),  
Temperature: -1°C ~ +10°C

A3325



**A connecting parts**

You choose this part of construction if you want to have a bar cooler in your bar unit, for example. The final product may look slightly different depending on the size of the product you want there, in addition to the bar cooler.

**for Type A construction**  
V1-015506-0019



**for Type B construction**  
V1-015506-0020

# TOP PLATE WITH REAR UPSTAND

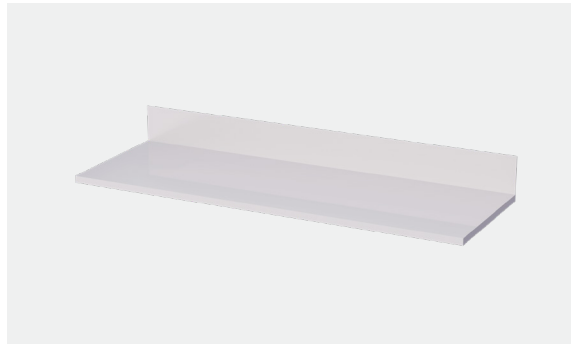

**The length of the countertop will depend on the total width of all your selected cabinets**

**Top plate for Type A construction**

V1-015506-0017

**Top plate for Type B construction**

V1-015506-0018

Finally, you can choose what you want on the top plate. It can be **Flat S/S top plate -> V1-015506-0124** or you can add a sink, a tub, a drip tray, etc.



**Insulated tub for ice  
(Removable bottom +siphon)  
300x450x300**

V1-015506-0115



**Insulated tub for ice  
(2 partitions)  
500x400x300**

V1-015506-0116



**Sink with glasswasher  
(PE cutting board +siphon)  
300x380x200**

V1-015506-0117



**Insulated tub for ice  
with 4x 1/9GN (1 partition)  
648x400x300**

V1-015506-0125



**Insulated tub for ice  
with 2x 1/3GN (1 partition)  
648x400x300**

V1-015506-0126





**Drip tray with drain  
300x450**

V1-015506-0118



**Drip tray with drain  
500x450**

V1-015506-0120



**Drip tray with drain  
500x250**

V1-015506-0122



**Drip tray with drain  
and glasswasher  
300x450**

V1-015506-0119



**Drip tray with drain  
and glasswasher  
500x450**

V1-015506-0121



**Drip tray with drain  
and glasswasher  
500x250**

V1-015506-0123

## OTHER ACCESSORIES

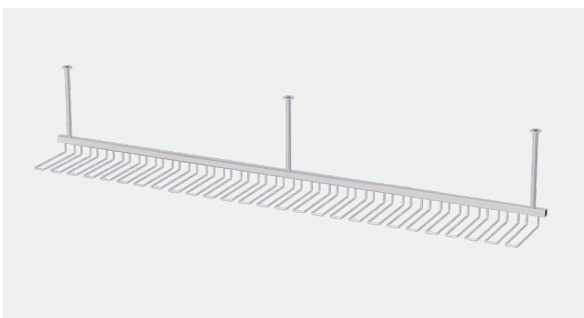

**Glass hanger**  
(1m maximum height of the mounting rods)

V1-015506-0127



**Shelf**  
(designed to be mounted on the front side)

V1-015506-0128



**GASTRO PRODUCTION S.R.O.**

ZEMĚDĚLSKÁ 500, KAMENNÝ ÚJEZD,  
373 81, CZECH REPUBLIC